

gl-gG, aM NH Dimension Knife-Blade Fuse-Links

NH Dimension Knife-Blade fuse-links, fuse bases, and accessories

Mersen NH Fuse-links, sizes 000, 00, 0, 1, 2, 3, 4 and 4a are rated 500 or 690 Volts AC with breaking capacities of 80kA or 120kA. All fuse-links include an indicator or striker and can accept a microswitch for remote signaling. They all have silver-plated knife blades and ceramic bodies. Accessories include 1, 2, 3 or 4-pole bases, barriers, shields, terminals, microswitch, etc.

gl-gG

Full Range Protection

- Sizes 000, 00, 0, 1, 2, 3, 4, 4a
- 500 and 690 Volt ratings - 2A through 800A
- All ratings include indicator
- All equipped for microswitch mounting

gl-gG

Full Range Protection Fuse-links with Striker

- Sizes 0, 1, 2, 3
- 500 and 690 Volt ratings - 32A through 630A
- All ratings include striker

aM

Short Circuit Protection

- • Sizes 000, 00, 0, 1, 2, 3
- • 400, 500 and 690 Volt ratings - 2A through 800A
- • All ratings include indicator
- • All equipped for microswitch mounting

aM

Short Circuit Protection Fuse-links with Striker

- Sizes 0, 1, 2, 3
- 500 and 690 Volt ratings - 2A through 630A
- All ratings include striker
- Certification
DIN 57636
VDE 60269
NFC 63210, 63211
IEC 269-1, 2, 2A
UNE 21103
- Approved by Lloyds Register of Shipping and Bureau Veritas



Standards:

- DIN 57636
- NFC 63210-63211
- IEC 269-1-2-2A
- UNE 21103
- VDE 0636-2-1, 2-2
- DIN 43620

Approvals:

- Lloyd's Register of Shipping
Bureau Veritas

aM NH Dimension Knife-Blade Fuse-Links

Catalog Numbers, Ratings – aM

Size	Rated Current (A)	Rated Voltage	Catalog Number	Interrupt Rating (A)	Std. Pack
000	2	690V	2C613	80,000	3
	4		2C619		3
	6		2C623		3
	10		2C631		3
	16		2C635		3
	20		2C637		3
	25		2C639		3
	32		2C643		3
	35		2C645		3
	40		2C647		3
	50		2C651		3
	63		2C655		3
00	50	690V	2C751	80,000	3
	63		2C755		3
	80		2C759		3
	100		2C763		3
	125		2C765		3
0	6	690V	2C023	80,000	3
	10		2C031		3
	16		2C035		3
	20		2C037		3
	25		2C039		3
	32		2C043		3
	35		2C045		3
	40		2C047		3
	50		2C051		3
	63		2C055		3
	80		2C059		3
	100		2C063		3
	125		2C065		3
	160		2C069		3
1	16	690V	2C135	80,000	3
	20		2C137		3
	25		2C139		3
	32		2C143		3
	35		2C145		3
	40		2C147		3
	50		2C151		3
	63		2C155		3
80	2C159	3			



Microswitch – Sizes 000 to 3

Catalog Number	Ref. Number	Std. Pkg.
MS4L2-5B6+PRES*	F210156	3
MS4L2-5B2+PRES**	G210157	3

*6.3 mm clips. **2.8mm clips

aM NH Dimension Knife-Blade Fuse-Links

Catalog Numbers, Ratings – aM

Size	Rated Current (A)	Rated Voltage	Catalog Number	Interrupt Rating (A)	Std. Pack		
1	100	690V	2C163	80,000	3		
	125		2C165		3		
	160		2C169		3		
	200		2C171		3		
	224		2C173		3		
	250		2C175		3		
2	35	690V	2C245	80,000	3		
	40		2C247		3		
	50		2C251		3		
	63		2C255		3		
	80		2C259		3		
	100		2C263		3		
	125		2C265		3		
	160		2C269		3		
	200		2C271		3		
	224		2C273		3		
	250		2C275		3		
	315		2C279		3		
	355		2C281		3		
	400		2C283		3		
3	250	690V	2C375	80,000	1		
	300		2C377		1		
	315		2C379		1		
	355		2C381		1		
	400		2C383		1		
	425		2C385		1		
	450		2C386		1		
	500		2CC387		1		
	630		500V		2B389	120,000	1
	800		400V		2A391	120,000	1

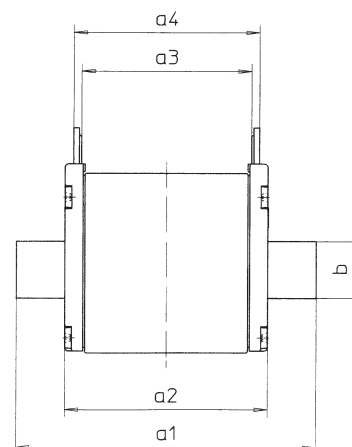

Dimensions (mm)

Size	Rated Current (A)	a1	a2	a3	a4	b	c1	e1	e2	e4	h
NH 690 V aM with voltage-conducting grip lug											
SIZE 000	2-35A	79	53,8	45	49	15	35,8	40	20	6	47,8
SIZE 00	40-100A	79	53,8	45	49	15	35,8	48	30	6	47,8
SIZE 1	16-160A	135	75	64	68	20	40	44	30	6	52
SIZE 1	200A	135	75	64	68	20	40	47	39	6	52
SIZE 2	35-100A	150	75	64	68	26	48	44	30	6	60
SIZE 2	125-315A	150	75	64	68	26	60	47	39	6	72
SIZE 3	250/300A	150	75	64	68	26	60	47	39	6	72
SIZE 3	315-425A	150	75	64	68	33	60	58	51	6	72
SIZE 3	500A	150	75	64	68	33	60	70	64	6	72

